

# MARVEL CRISIS PROTOCOL MINIATURES GAME

CP220

## READ THIS FIRST

Be sure to use a pair of sharp hobby clippers to remove the miniature components from the frame. Carefully clean the excess material and mold lines with a sharp hobby knife. Check the fit of each part before gluing. Use a small amount of hobby plastic glue to assemble the components. Use caution with all products and follow all manufacturer instructions. Adult supervision is recommended for children under the age of 16. Have fun!

## JOIN THE COMMUNITY

Use #PaintingProtocol to share your miniature photos and be a part of the Marvel: Crisis Protocol community!



AtomicMassGames



AtomicMassGames



Atomic\_Mass\_Transmissions

## BLADE ASSEMBLY GUIDE (A)

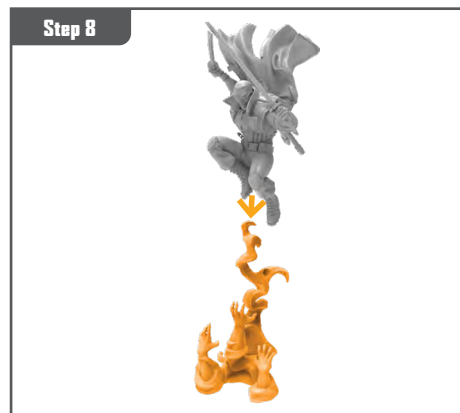
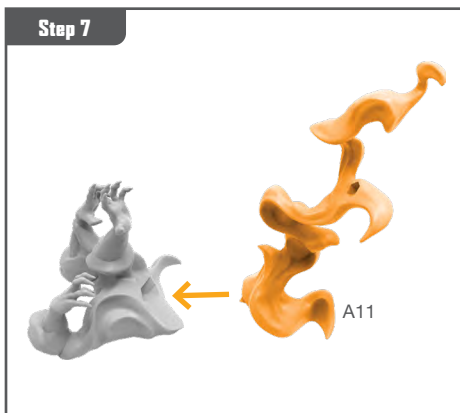
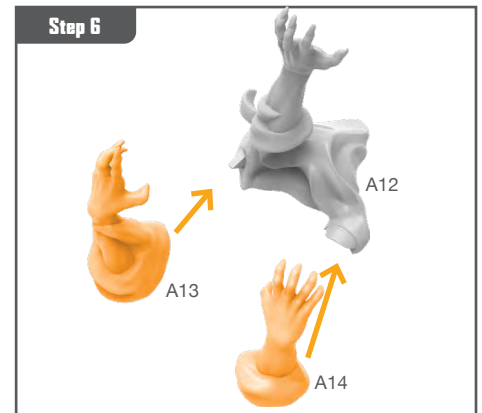
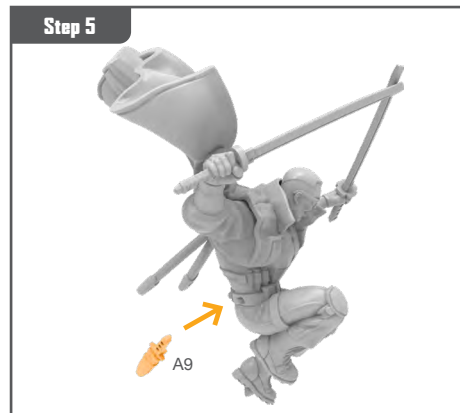
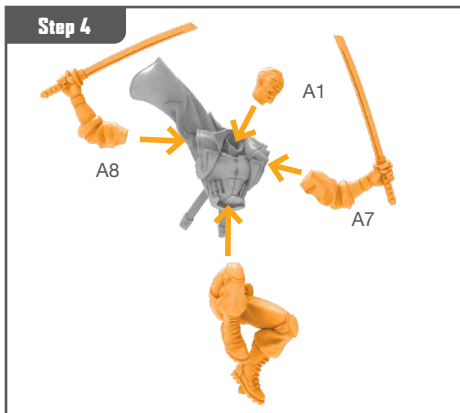
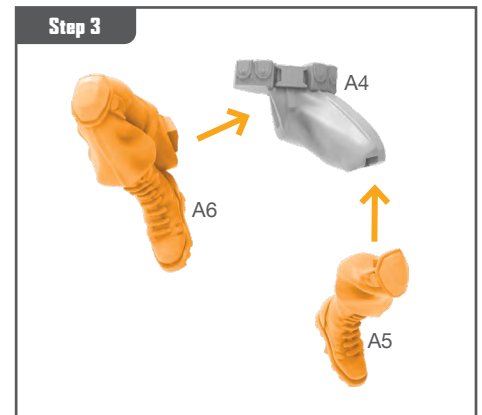
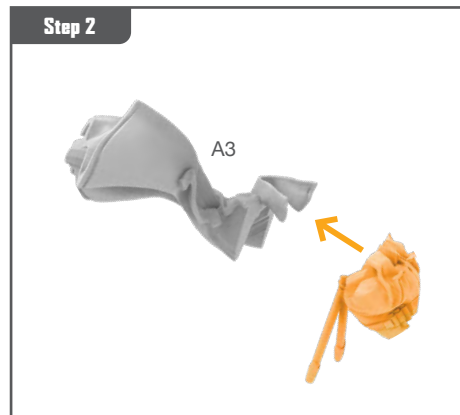
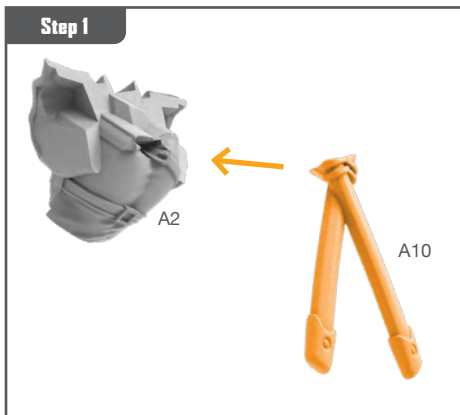

Permission granted to print or photocopy for personal use.



Atomic Mass Games and logo are TM of Atomic Mass Games.  
Atomic Mass Games, 1995 County Road B2 W, Roseville, MN, 55113, USA, 1-651-639-1905.  
Actual components may vary from those shown.

# MOON KNIGHT ASSEMBLY GUIDE (B)

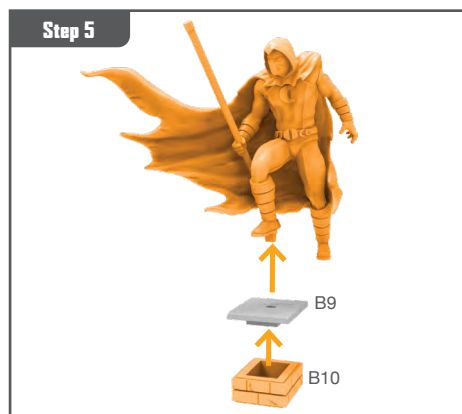
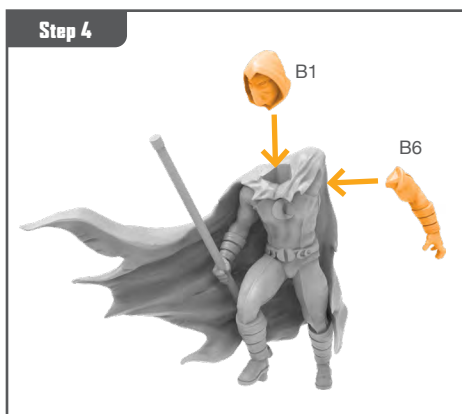
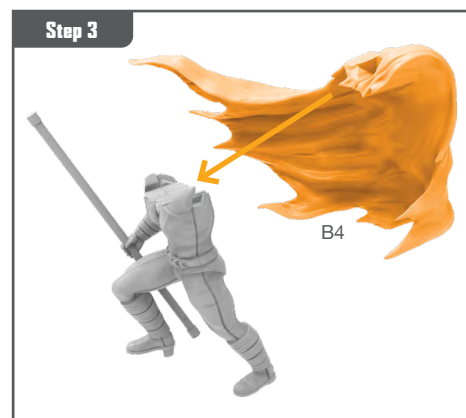
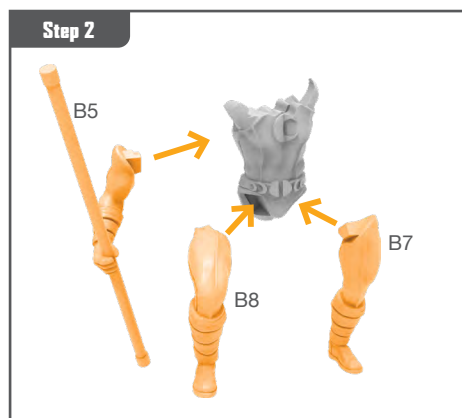
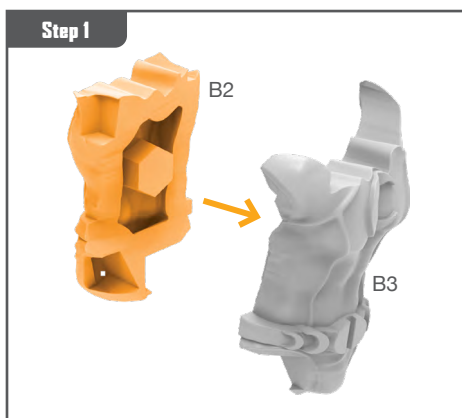

# DOCTOR VODDOD ASSEMBLY GUIDE (A)

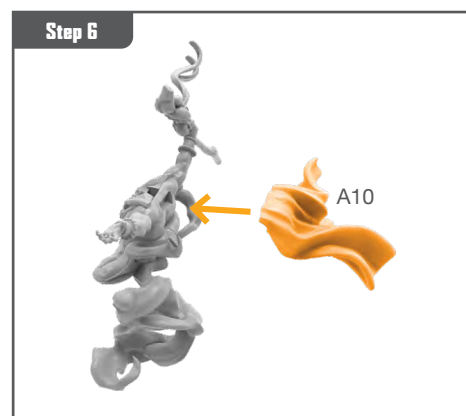
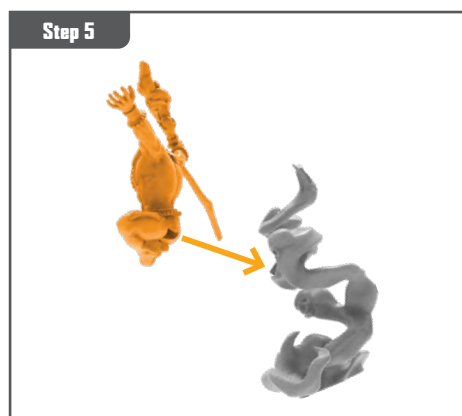
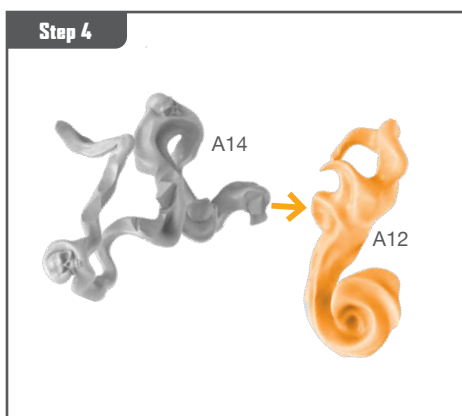
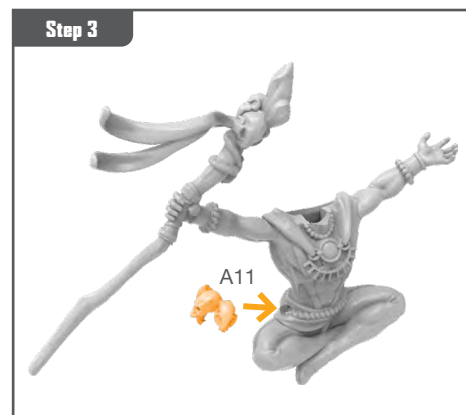
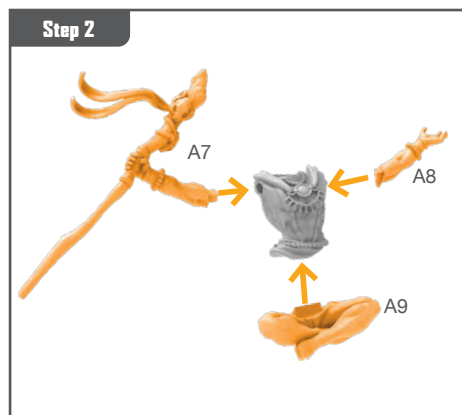
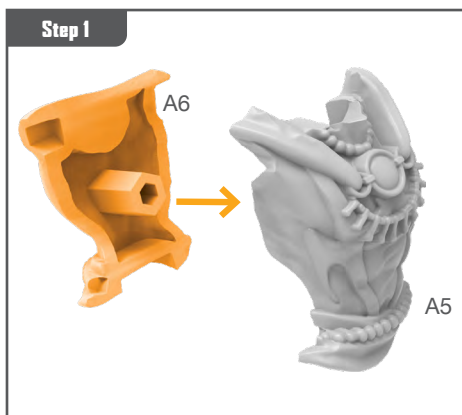

Permission granted to print or photocopy for personal use.

# DOCTOR VODDOO ASSEMBLY GUIDE (A)

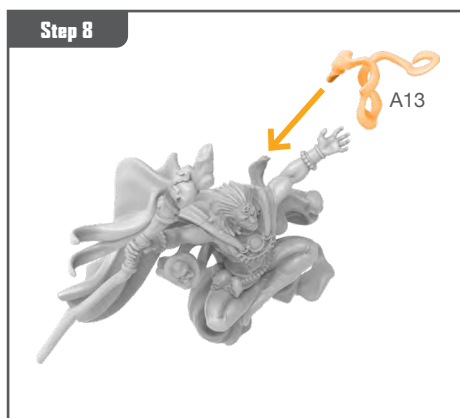
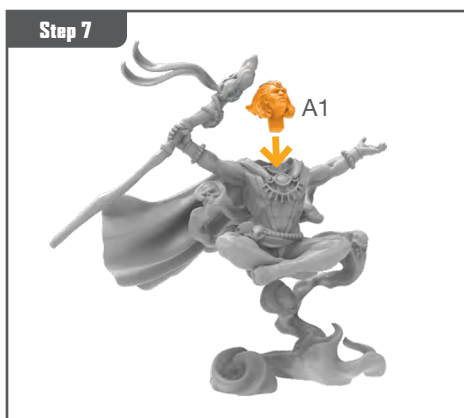

# GHOST RIDER ASSEMBLY GUIDE

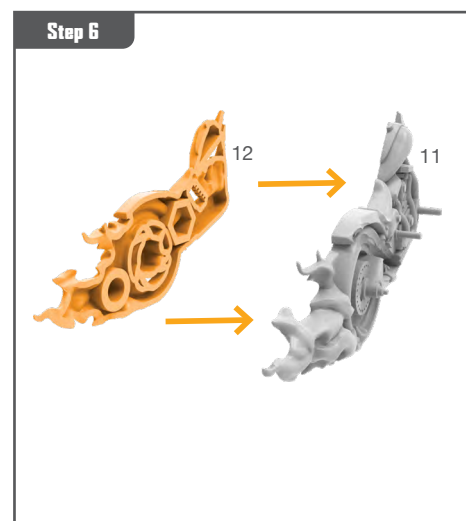
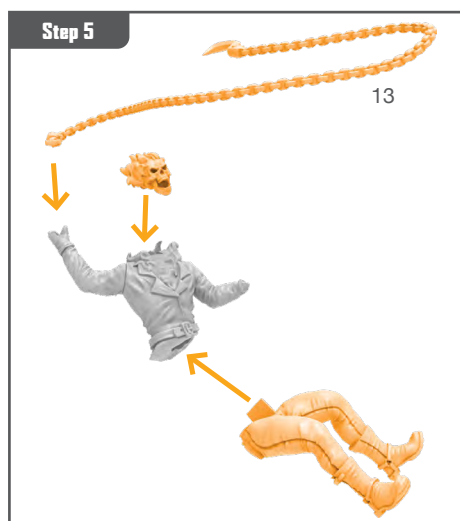
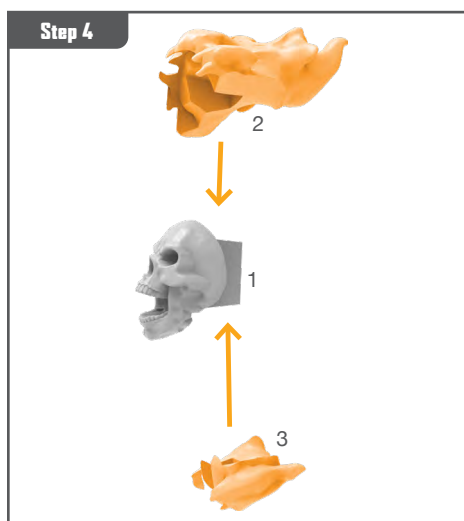
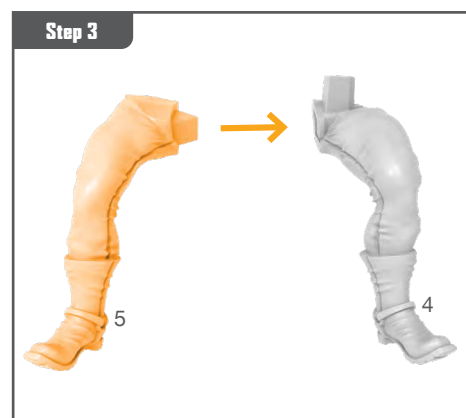
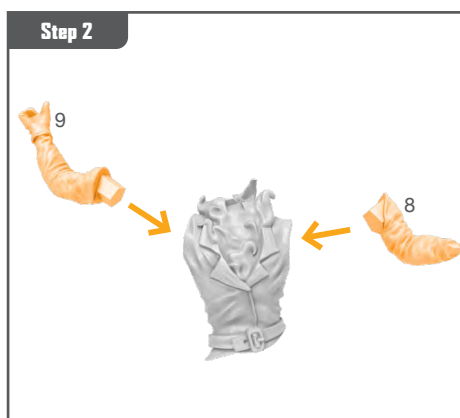
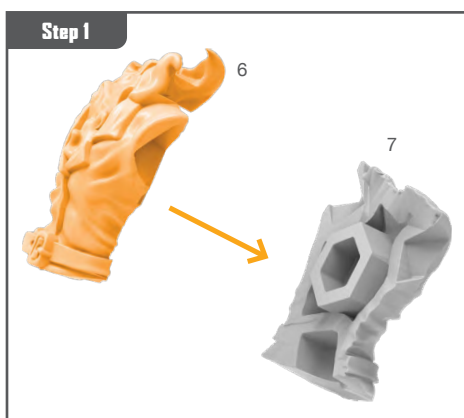

Permission granted to print or photocopy for personal use.



Atomic Mass Games and logo are TM of Atomic Mass Games.  
Atomic Mass Games, 1995 County Road B2 W, Roseville, MN, 55113, USA, 1-651-639-1905.  
Actual components may vary from those shown.

# GHOST RIDER ASSEMBLY GUIDE (CONTINUED)

Step 7

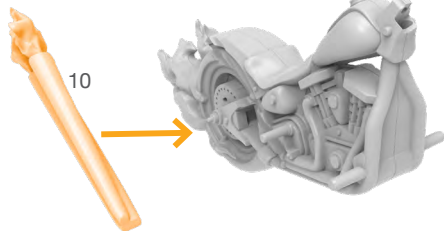

Step 8

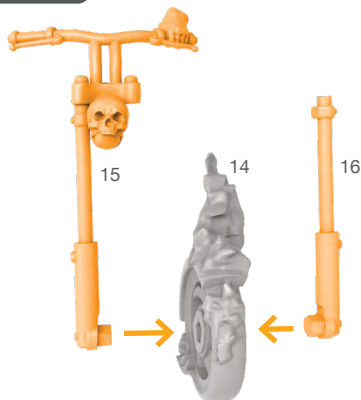

Step 9

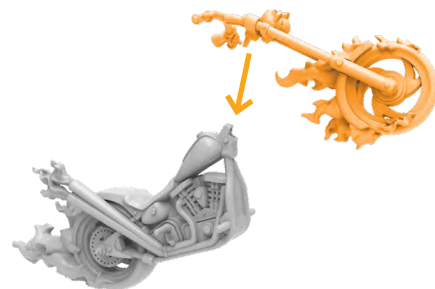

Step 10



Attach Base



Permission granted to print or photocopy for personal use.



Atomic Mass Games and logo are TM of Atomic Mass Games.  
Atomic Mass Games, 1995 County Road B2 W, Roseville, MN, 55113, USA, 1-651-639-1905.  
Actual components may vary from those shown.