

MARVEL

CRISIS PROTOCOL

MINIATURES GAME

CP 05

READ THIS FIRST

Read through the instruction booklet before assembling your miniatures. Be sure to use a pair of sharp hobby clippers to remove the miniature components from the sprue. Carefully clean the excess material and mold lines with a sharp hobby knife. Check the fit of each part before gluing. Use a small amount of hobby plastic glue to assemble the components. Use caution with all products and follow all manufacture instructions. Adult supervision is recommended for children under the age of 16. Have fun!

CREDITS

Marvel Crisis Protocol

Game and Character Design

William Shick

Lead Developer

Will Pagani

Sculpting Director

Dallas Kemp

Digital Engineering

Marco Segovia

Sculptor

Doug Hamilton/Marco Segovia

Miniature Painting

Brendan Roy

Graphic Design & Photography

Jessy Stetson

Editing

Darla Kennerud

Art Director

Zoë Robinson

Asmodee North America

Licensing Coordinator

Sherry Anisi

Licensing Manager

Simone Elliott

Plastics Production Management

Justin Anger, Michael Blomberg

Print Production Management

John Hannasch, Liza Lundgren

Publisher

Steve Horvath

Marvel

Licensing Approvals

Brian Ng



Atomic Mass Games and logo are TM of Atomic Mass Games. Atomic Mass Games, 1995 County Road B2 W, Roseville, MN, 55113, USA, 1-651-639-1905. Actual components may vary from those shown.

M.O.D.O.K. ASSEMBLY GUIDE

Step 1

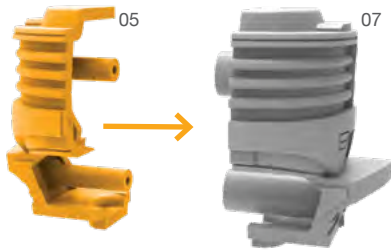

Step 2

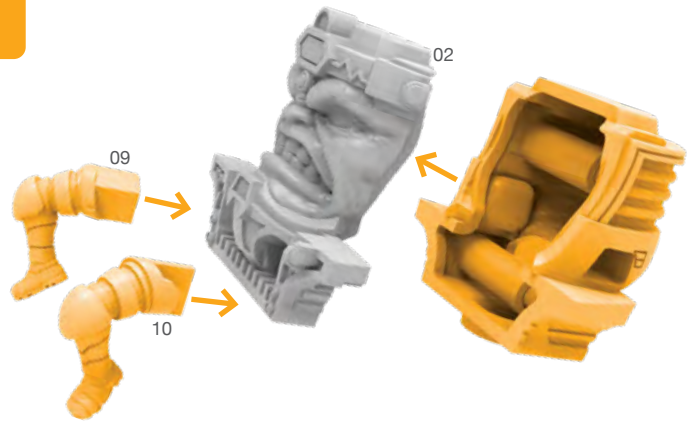

Step 3



Step 4

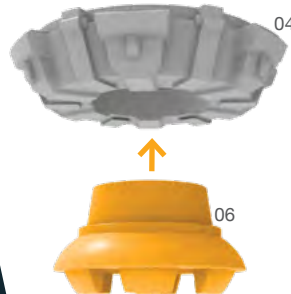

Step 5

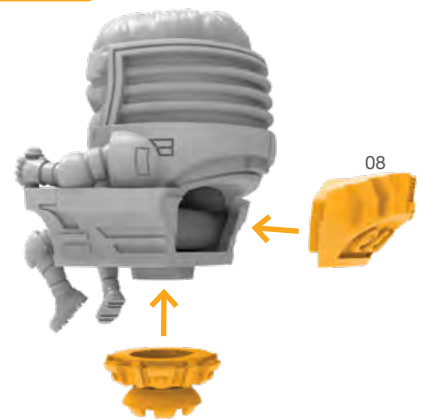

Step 6

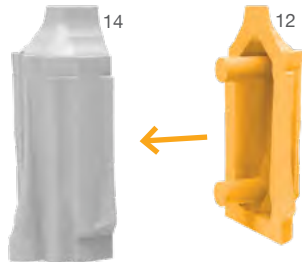

Step 7

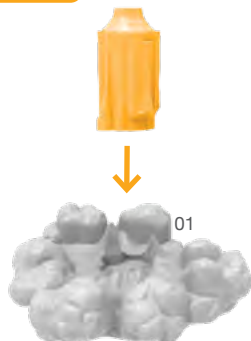

Step 8

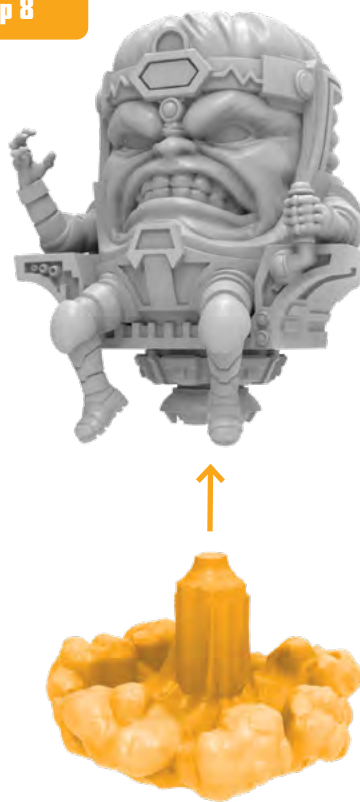

Attach Base



MARVEL
CRISIS PROTOCOL
MINIATURES GAME